

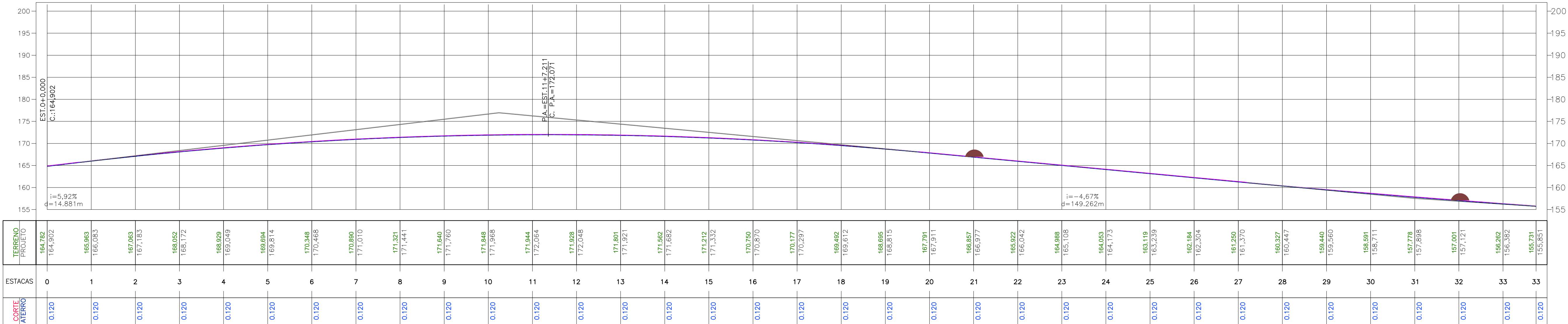

PERFIL LONGITUDINAL PE - 10 ESC. V.: 1:500

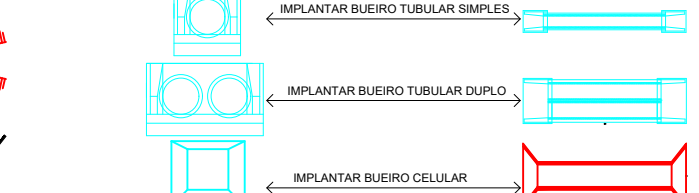

PERFIL LONGITUDINAL PE - 10 ESC. V.: 1:500

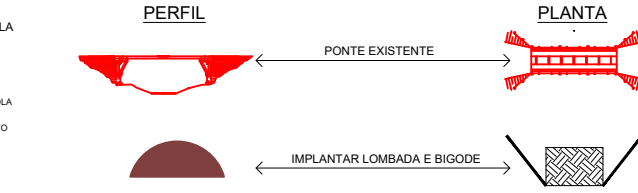
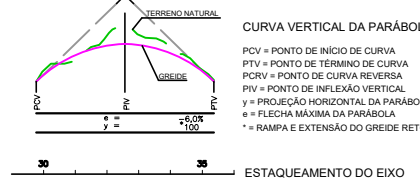
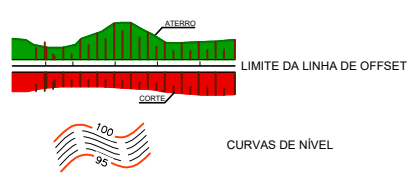
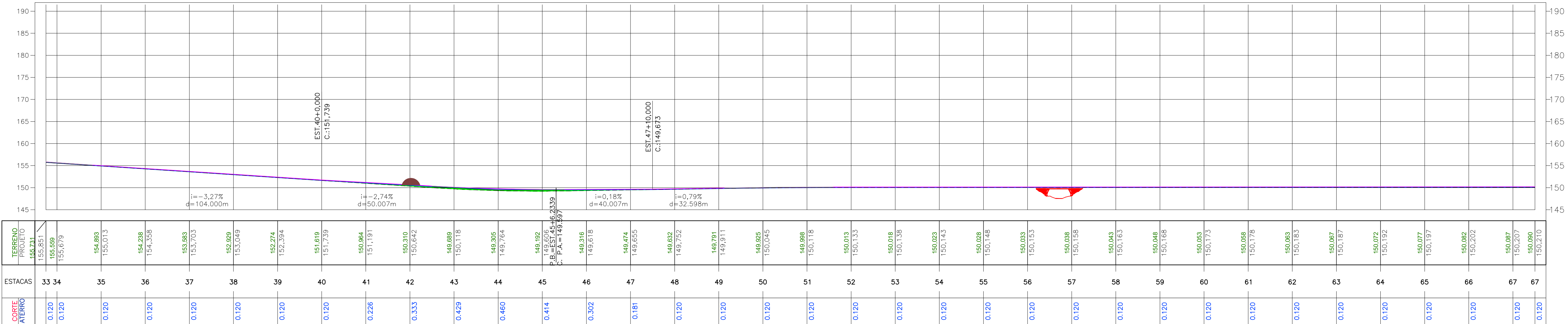

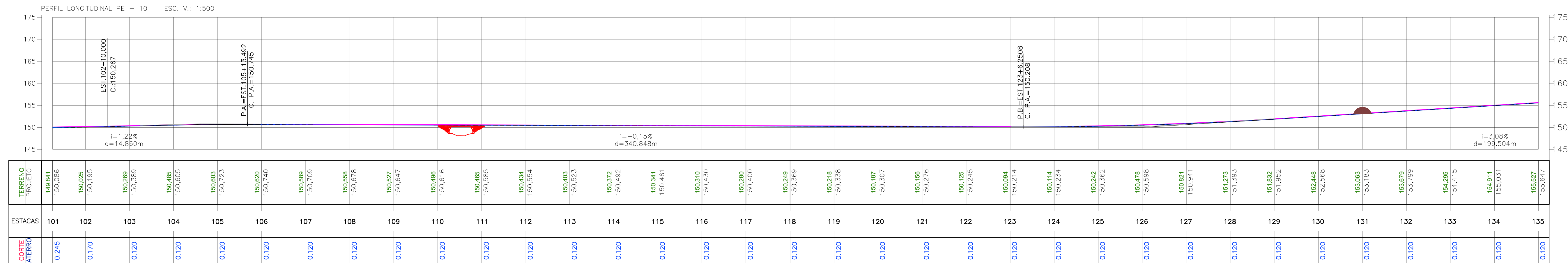
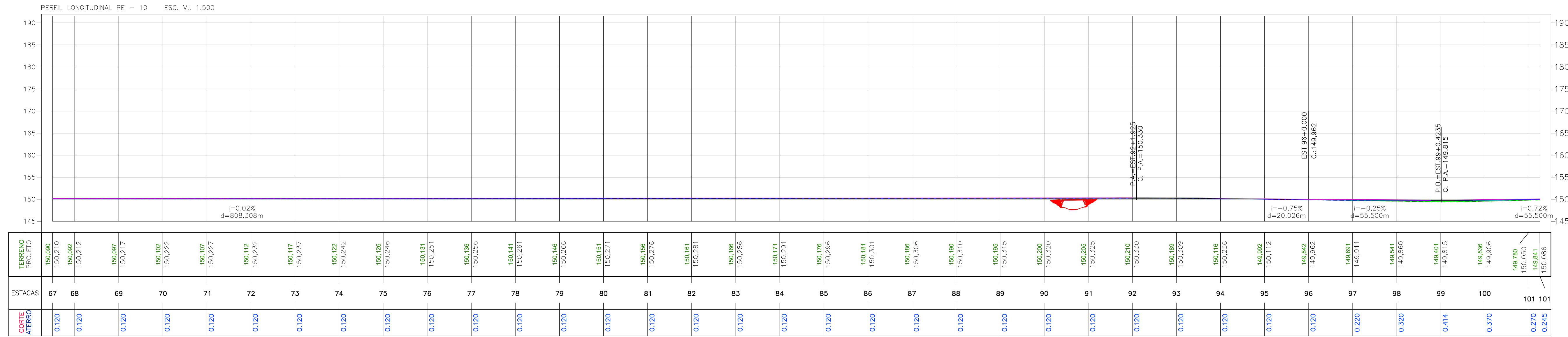

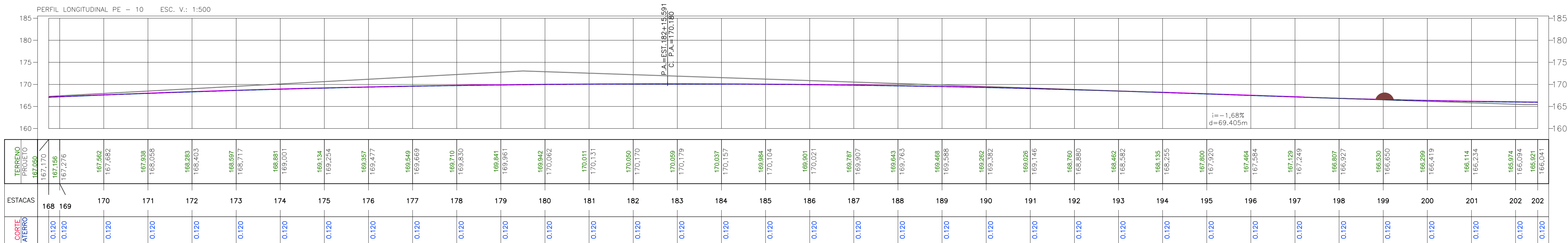
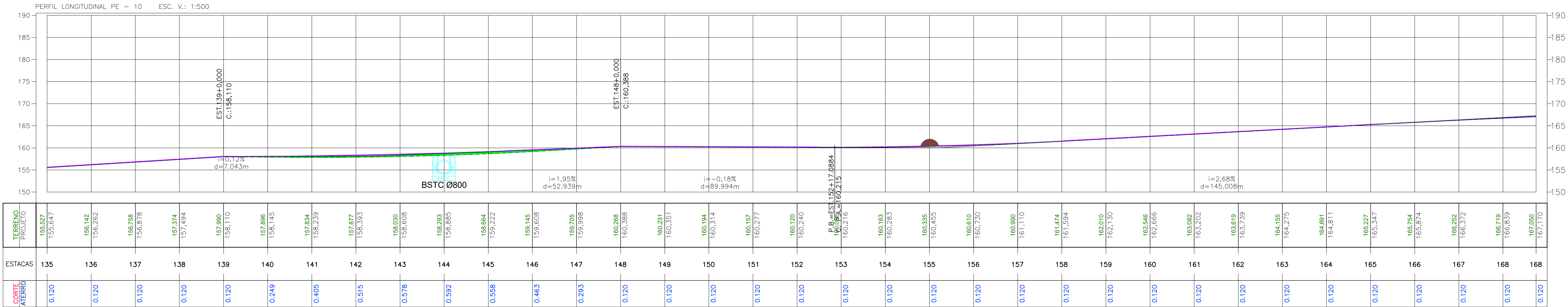

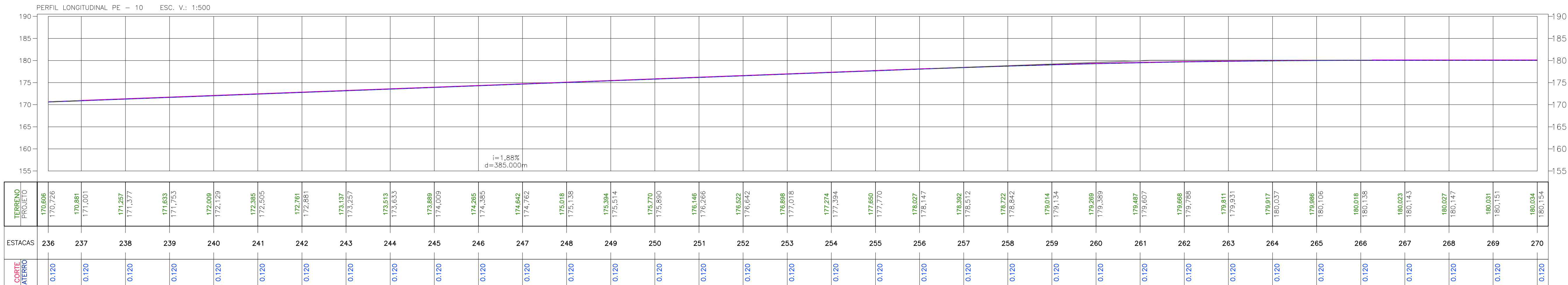
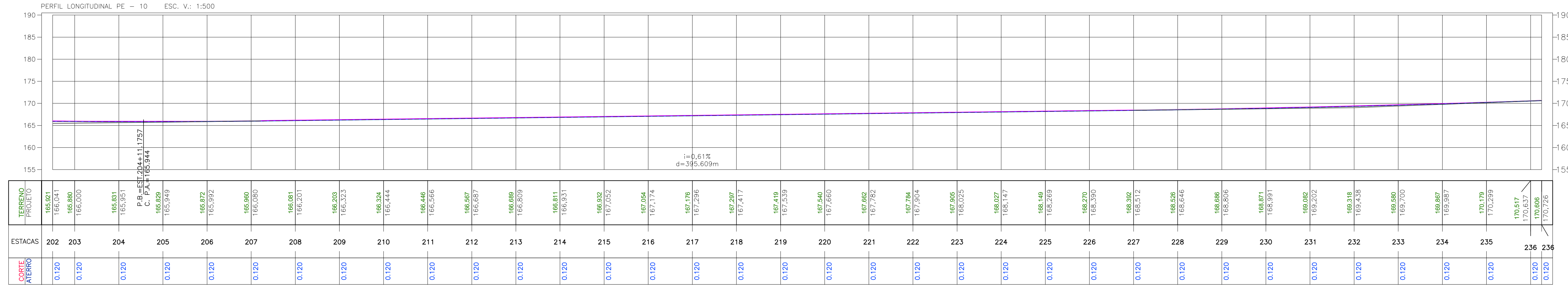

LEGENDA:

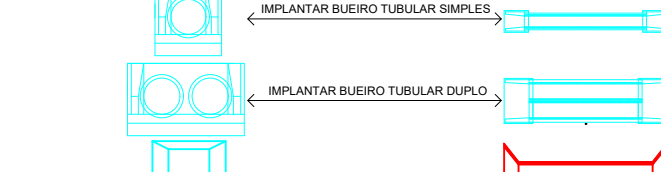
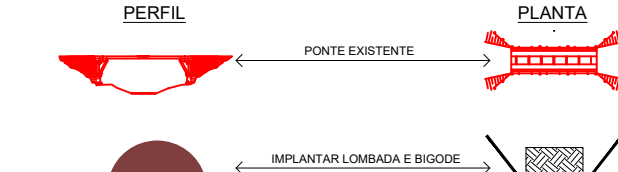
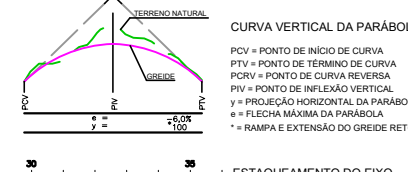
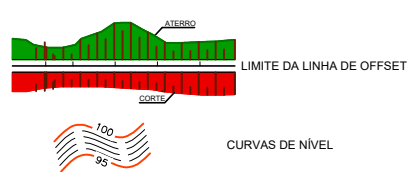

APROVAÇÃO
PREFEITURA MUNICIPAL DE PORTO ESPERIDIÃO

LUIS FELIPE CARVALHO B. LIMA
PROJETO GEOMÉTRICO
CREMAT 121.923.954-8

OBRA ADEQUAÇÃO DE ESTRADAS VICINAIS

PROPRIETÁRIO: PREFEITURA MUNICIPAL DE PORTO ESPERIDIÃO

LOCAL: DIVERSAS ESTRADAS DO MUNICÍPIO

ASSUNTO: PROJETO GEOMÉTRICO

DATA: ABRIL / 2025

FOLHA 141

04

/144

0 1 2 3 4 5
cm

